

Type TJL2.5 Tilt Jib (Long)

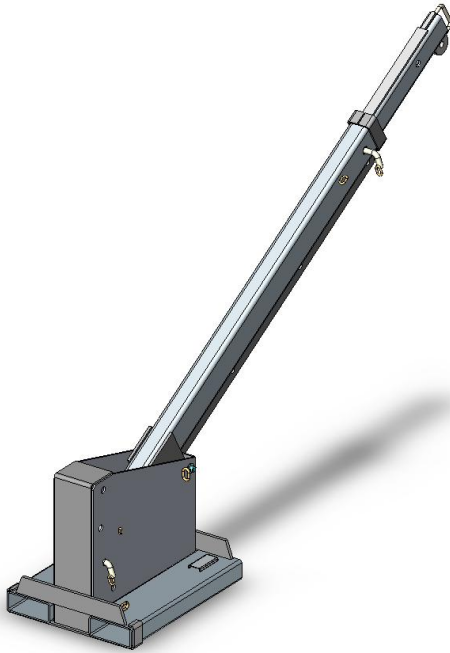

The type TJL2.5 Tilt Jib (Long) is the most versatile Forklift Jib attachment in our range, allowing extra height to 2.48 metres, with a 3.58 metre reach when fully extended. This slip-on attachment is held to the Forklift by a safety chain. The Jibs overall length when closed is 2.15 metres.

The standard finish on the type TJL2.5 Tilt Jib (Long) is Zinc Plated.

SPECIFICATIONS:

- Safe Working Load (SWL) 2500kg Max.
- Unit Weight 180kg
- Load Centre 1005mm
- Pocket Size 165 x 65
- Pocket Centres 337 mm
- Horizontal C of G 1010mm
- Vertical C of G 225mm

