

Type DL1000 Drum Lifter

The type DL1000 Drum Lifter would be considered the safest Drum Lifter available. This unit ensures 205 litre steel Drums are moved with 100% security. The Drum is quickly clamped into the support via the dual Chain Belly Strap & eccentric lock. A further safety catch prevents accidental release.

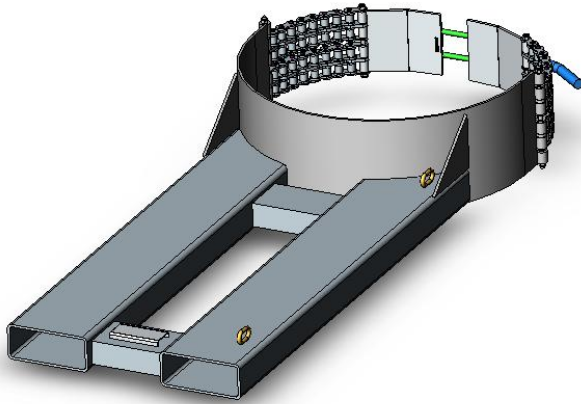

SPECIFICATIONS:

- Safe Working Load (SWL) 1000kg
- Load Centre 1160mm nominal
- Unit Weight 60kg
- Pocket Size 165 x 65mm
- Pocket Centres 335mm
- HCG 710mm
- VCG -25mm

