

## Type DC-T Cord Operated Drum Rotator

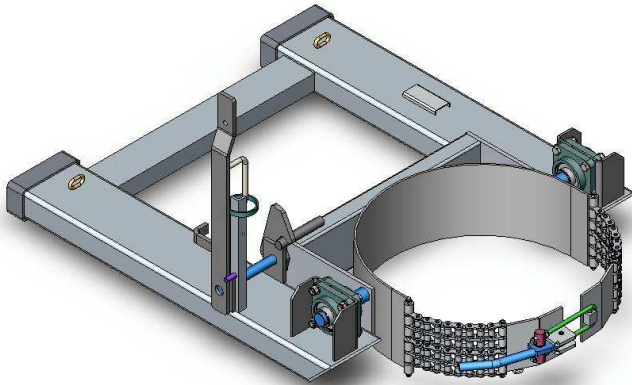

The type DC-T Cord Operated Drum Rotator is designed for fast and economical 205 litre drum emptying. A Chain Belly Strap with an eccentric lock holds the Drum firmly in position. To release the drum the Operator pulls the draw chord from the driver's seat. With the drum C of G forward of the pivot point, the drum tips forward 180°+ automatically.

This unit is ideal for scrap and waste products. The standard finish is painted enamel.

### SPECIFICATIONS:

- Safe Working Load (SWL) 500kg
- Unit Weight 100kg
- 180°+ Rotation
- Load Centre 1040mm
- Pocket Size 165 x 65
- Pocket Centres 825mm
- Horizontal C of G 900mm

